

## Postdoc and Work Meeting

Manchester University, Atlas-1 Lecture Hall, Kilburn Building  
Friday 7th of October 2016

---

**9:00-9:15 Welcome and Introduction** (Angelo)

9:15-11:15 Presentations by BABELonians

30 Berlin Experiments (Friedemann, Max)

30 Berlin/Plymouth Large Scale Modeling (Max, Rosario, Thomas)

30 Manchester Hardware (Steve, Alex)

15 Plymouth Learning rules (Michael)

15 Plymouth Robotics (Daniel)

**11:15 - 11:45 Coffee/Tea**

11:45 - 12:45 Invited talk

Giorgio Metta/Chiara Bartolozzi A neuromorphic humanoid robot

**12:45 - 13:45 lunch break** (buffet at workshop location)

13:45-15:45 Invited talks

Marc-Oliver Gewaltig Neurorobotics in the Human Brain project

Paul Verschure TBA

**15:45-16:00 Coffee/Tea**

16:00-17:00 Invited talk

Lawrence Barsalou      What does semantic tiling of the cortex tell us about semantics?

**17:00 End of Workshop**

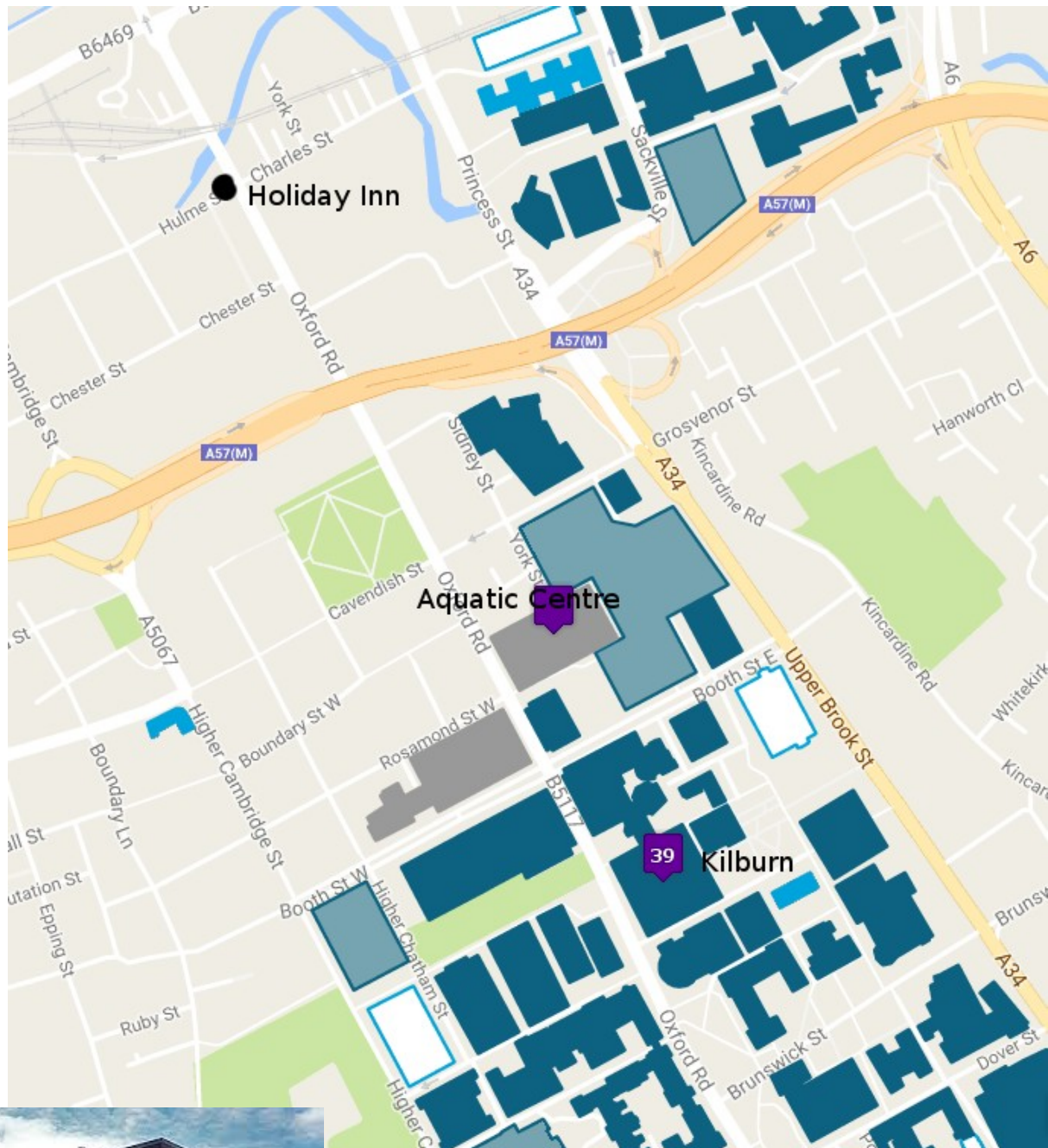

Kilburn Bldg

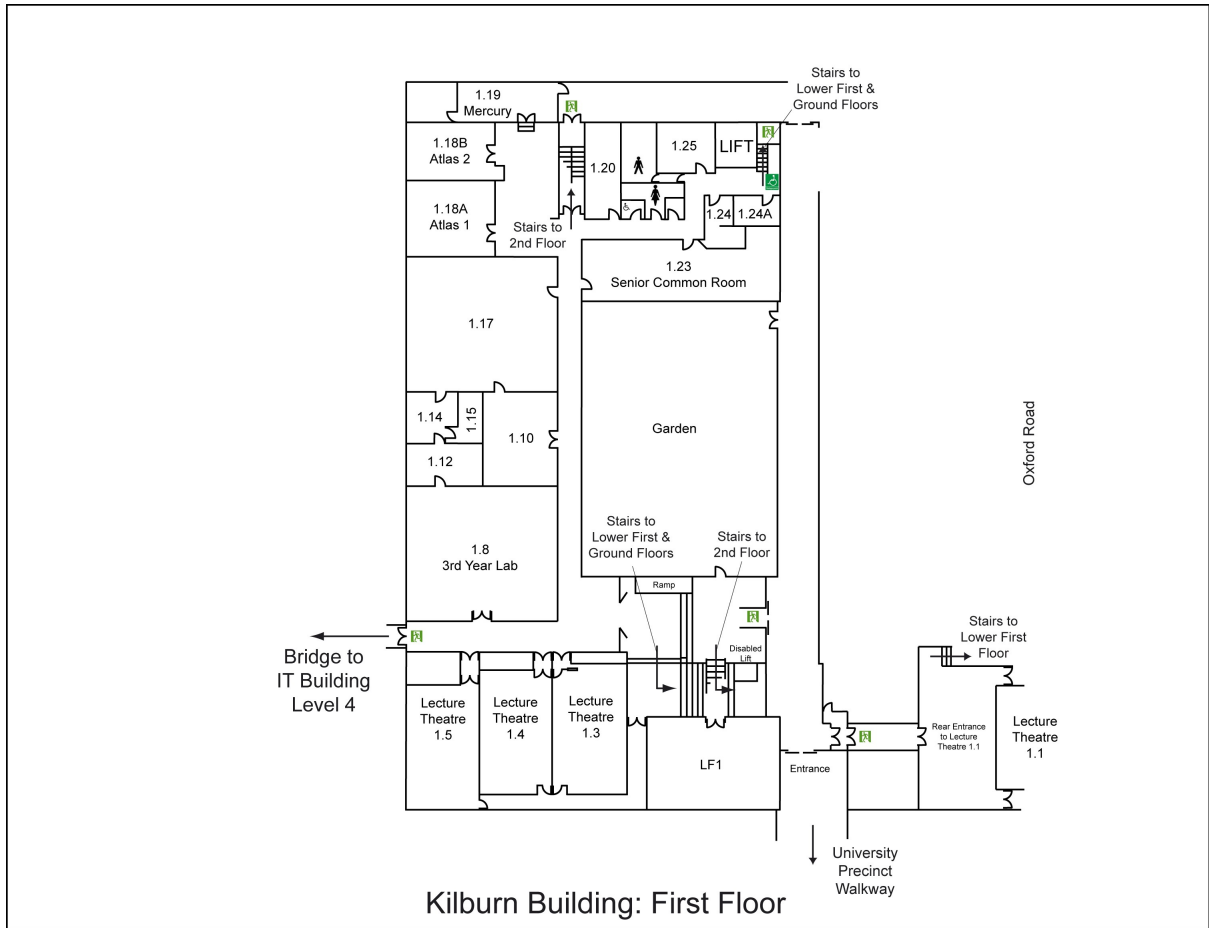

Kilburn Building: First Floor